

RED LODGE DRILLING INVESTIGATION

MONTANA DEPARTMENT OF
ENVIRONMENTAL QUALITY, ABANDONED
MINE LANDS DIVISION

Bill Snoddy – Project Manager at DEQ

PIONEER TECHNICAL SERVICES, INC.

Tim Ranf – Project Manager at Pioneer

RED LODGE DRILLING INVESTIGATION

- ▣ Work Ongoing this year (since January):
 - Survey and Monitoring of 3 residences:
 - ▣ 501 Broadway
 - ▣ 505 Platt
 - ▣ 404 S. Broadway
 - Established survey monitoring points and control, crack gauges.
 - Monitoring quarterly to determine if active settlement is occurring. Next event – July.
 - No settlement measured to date (January & April).
- ▣ Additional House to be added at 207 S. Hauser

RED LODGE MONITORING LOCATIONS - 501 BROADWAY

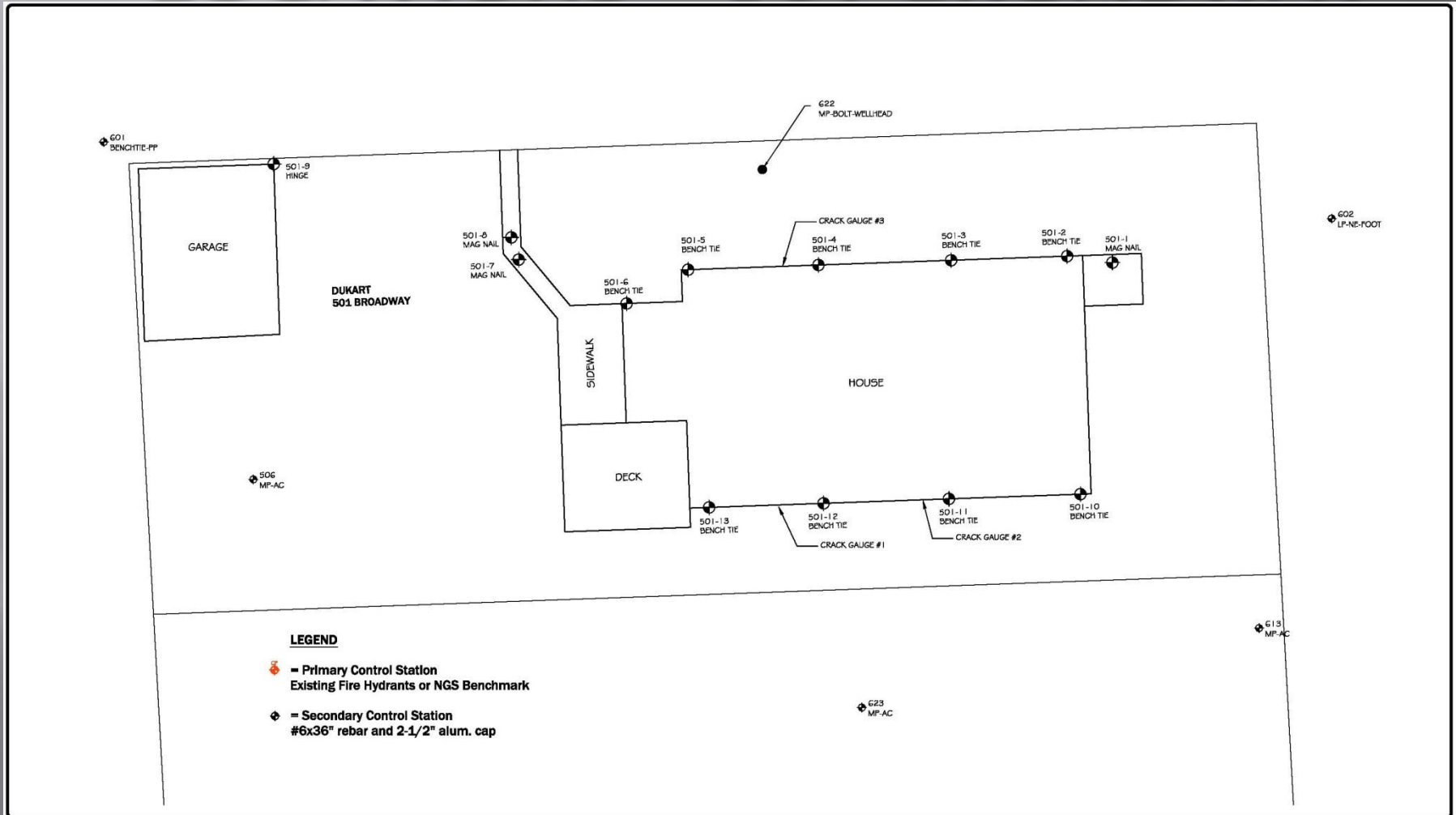

DISPLAYED AS	
COORD SYS/TONE	MT STATE PLANE COORDINATES
DATUM	NAD83(2011)
UNITS	INTERNATIONAL FEET
SOURCE	OPUS & NGS BENCHMARK
SCALE IN FEET	
0 5 10	

FIGURE 2

501 BROADWAY

PIONEER
TECHNICAL SERVICES, INC.
201 E. BROADWAY, SUITE C
HELENA, MT 59601
(406) 457-8252

DATE 02/04/2014

RED LODGE DRILLING INVESTIGATION

- ▣ OBJECTIVE – Determine whether historic underground coal mines have any potential for causing (or have caused) ground subsidence.
 - In response to concerns from several citizens.
 - Based on previous investigations and historic mine maps, the mine workings are very deep – 250- to 900-feet below the ground surface in this area.
- ▣ Outcome from the drilling investigation and survey monitoring will be used to determine whether or not ground subsidence has or could occur as a result of collapsing underground mine workings.

RED LODGE DRILLING INVESTIGATION SITE MAP SHOWING PROPOSED BOREHOLE LOCATIONS



KEY:
 ● DENOTES PROPOSED BOREHOLE LOCATIONS
 ▲ DH-2; CHEN-NORTHERN, 1987

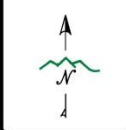

DISPLAYED AS: _____
 COORD SYS/ZONE: NAD83
 DATUM: NAD83
 UNITS: FT
 SOURCE: NAIP 2013

SCALE IN FEET
 0 150 300

FIGURE 1 RED LODGE DRILLING INVESTIGATION BORE HOLE LOCATIONS

PIONEER
 TECHNICAL SERVICES, INC.
 201 E. BROADWAY, SUITE C
 HELENA, MT 59601
 (406) 457-8252

DATE: 6/19/14

RED LODGE DRILLING INVESTIGATION MINE WORKINGS VIEW

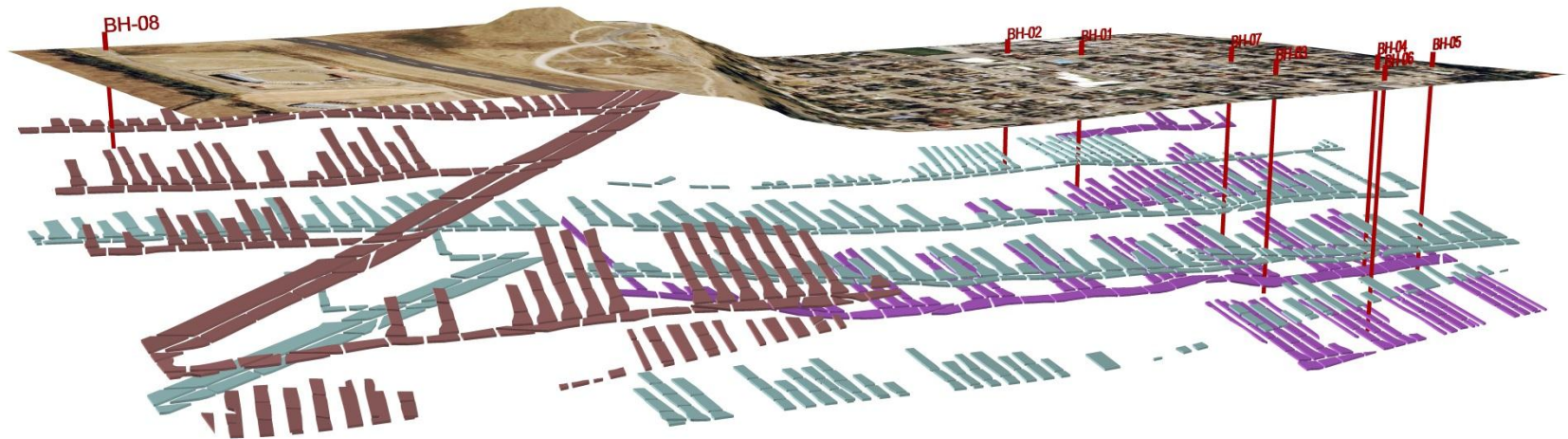

RED LODGE DRILLING INVESTIGATION MINE WORKINGS VIEW

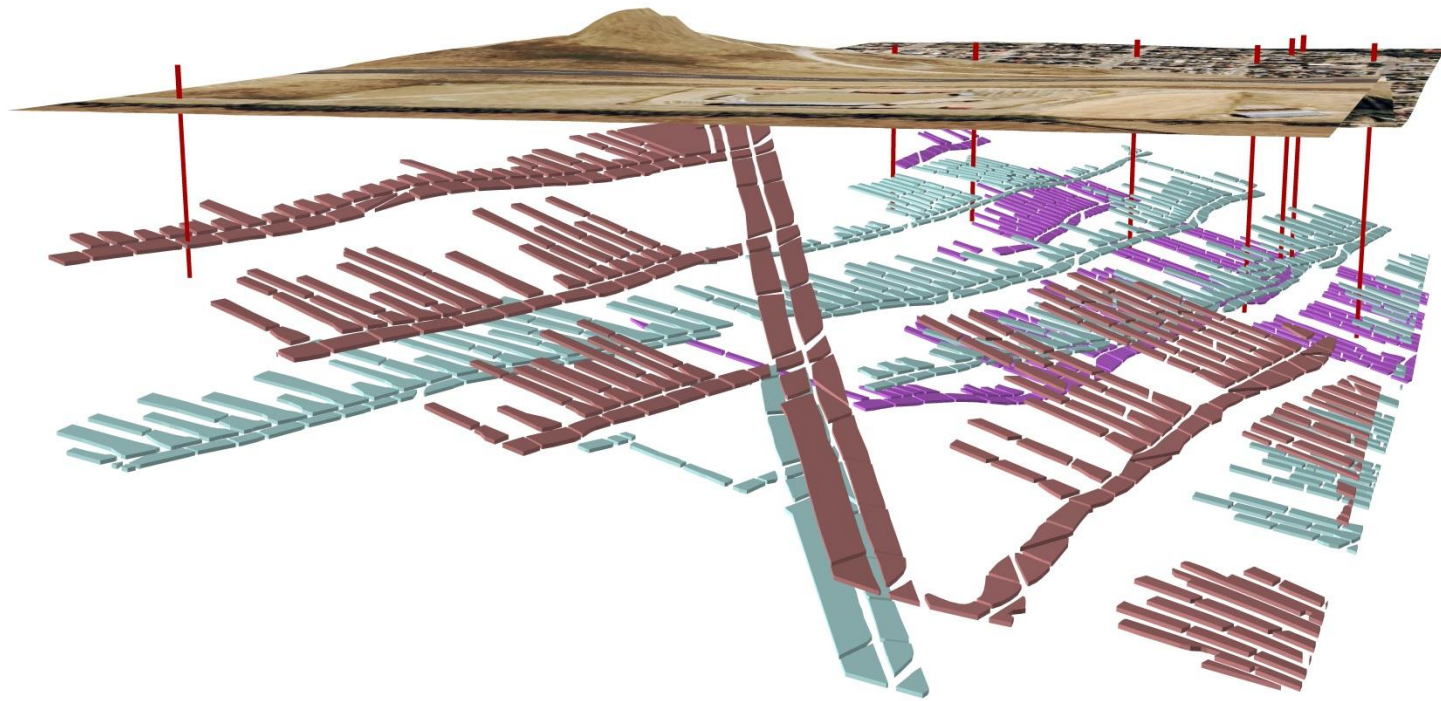

RED LODGE DRILLING INVESTIGATION CONCEPTUAL CROSS SECTION

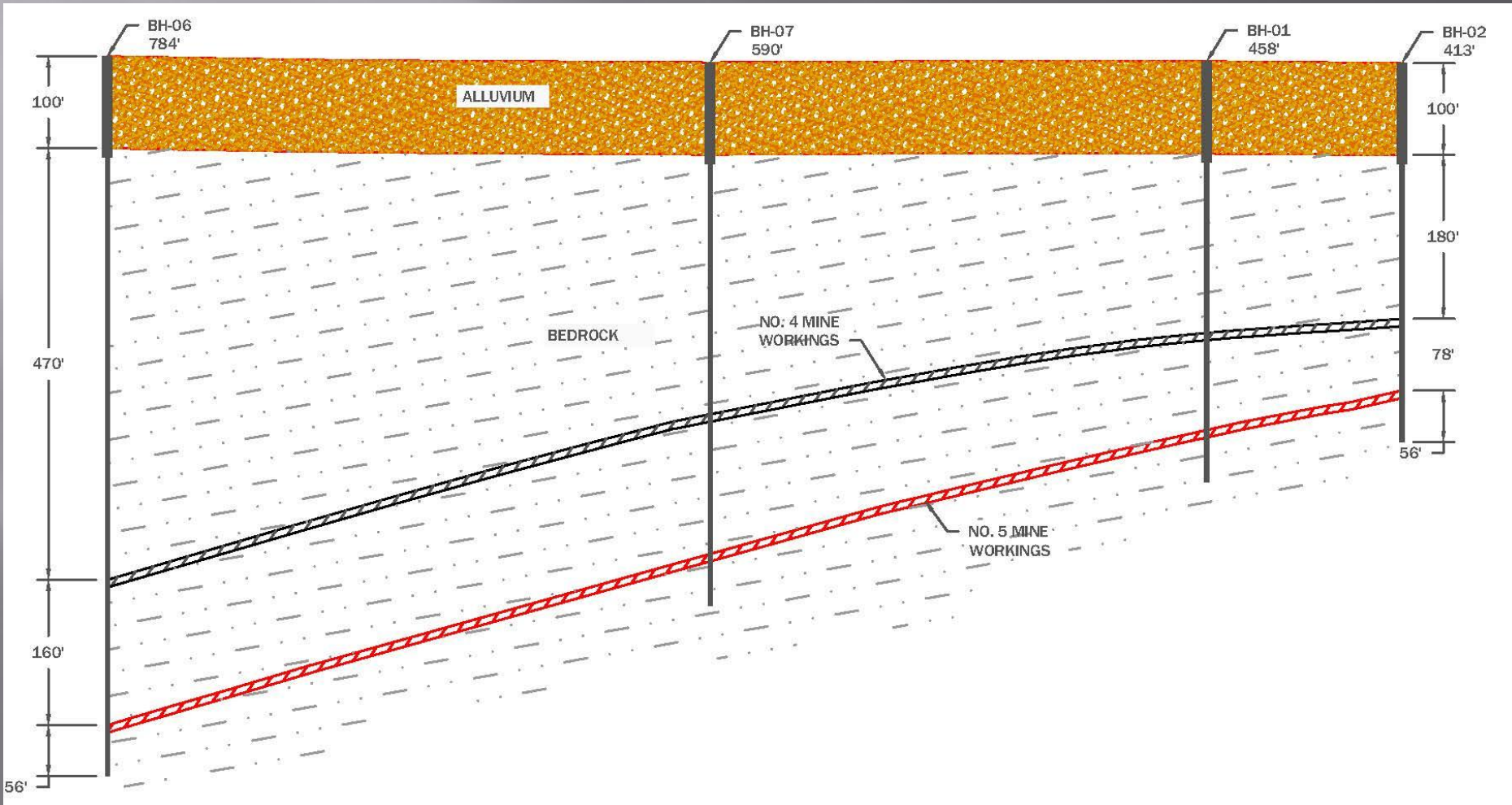

RED LODGE DRILLING INVESTIGATION

▣ SCHEDULE

- Requests for Bids for drilling contractor currently out.
- Select Drillers July 1
- Start Drilling August 4
 - ▣ Drilling activities 8 AM to 6 PM Monday – Saturday
 - ▣ Possibly have two drill rigs operating simultaneously for a couple weeks
- Drilling complete September 26
- Final Report December 22