



NOTICE OF PUBLICATION OF CATEGORICAL EXCLUSION
BROADUS, MONTANA
SRF PROJECT#: C303705

LIFT STATION & LAGOON IMPROVEMENTS

July 22, 2019

The Montana Department of Environmental Quality has reviewed the above-named project. Due to permit violations, along with safety and reliability concerns with the existing influent lift station, the Town of Broadus has identified the need for the installation of a new influent lift station, a new influent splitter structure, an internal recirculation line, and the placement of riprap on the interior slopes of the Cell #3 embankments. The existing lift station is over 50 years old and is reaching the end of its useful life. The lift station pumps are located 18 feet below grade in a dry well, making them difficult to service and creating an unsafe environment for the operators to work in. The new lift station will have submersible pumps and valves located above-ground simplifying maintenance activities and eliminating the need for the operators to enter a confined space. The pumps, mounted on guide rails, can be removed from the wet well using a davit crane. The new lift station will also be equipped with a standby generator and a telemetry system to notify the operator of emergency alerts. The construction of a new influent splitter structure will prevent short circuiting within Cell #1 and the installation of an internal recirculation line will bring oxygenated water from Cell #3 to Cell #1, resulting in improved treatment of the community's wastewater. The installation of riprap in Cell #3 will prevent further embankment erosion, provide embankment stability, and prevent sediment from contributing to total suspended solids violations.

Pursuant to ARM 17.40.318, the Montana Department of Environmental Quality has concluded that the proposed project meets the Categorical Exclusion criteria of the National Environmental Policy Act (NEPA) and the Montana Environmental Policy Act (MEPA). The Categorical Exclusion may be revoked if the project is not initiated within the time period specified in the Preliminary Engineering Report, a new or modified application is submitted, or new evidence demonstrates serious local or environmental issues exist, or state, local, tribal, or federal laws are violated.

The documentation for the Categorical Exclusion is available for public review at the following locations:

Mike Abrahamson, P.E.
Department of Environmental Quality
State Revolving Fund Loan Program
1520 East Sixth Avenue
Helena, MT 59601
mabrahamson@mt.gov

Milton Amsden, Mayor
Town of Broadus
210 Holt St.
Broadus, MT 59317
Phone (406) 436-2409

Sincerely,

A handwritten signature in blue ink, appearing to read "Kevin B. Smith", written over a horizontal line.

Kevin B. Smith, Bureau Chief
Engineering Bureau
Water Quality Division
Montana Department of Environmental Quality

C:\PROJECTS\2018\18-00-025 - Broadus Task Order No. 3\025.1 - Lift Station & Lagoon\AD\SITE PLAN.dwg 5/28/2019 10:02:48 AM

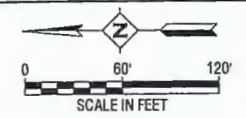
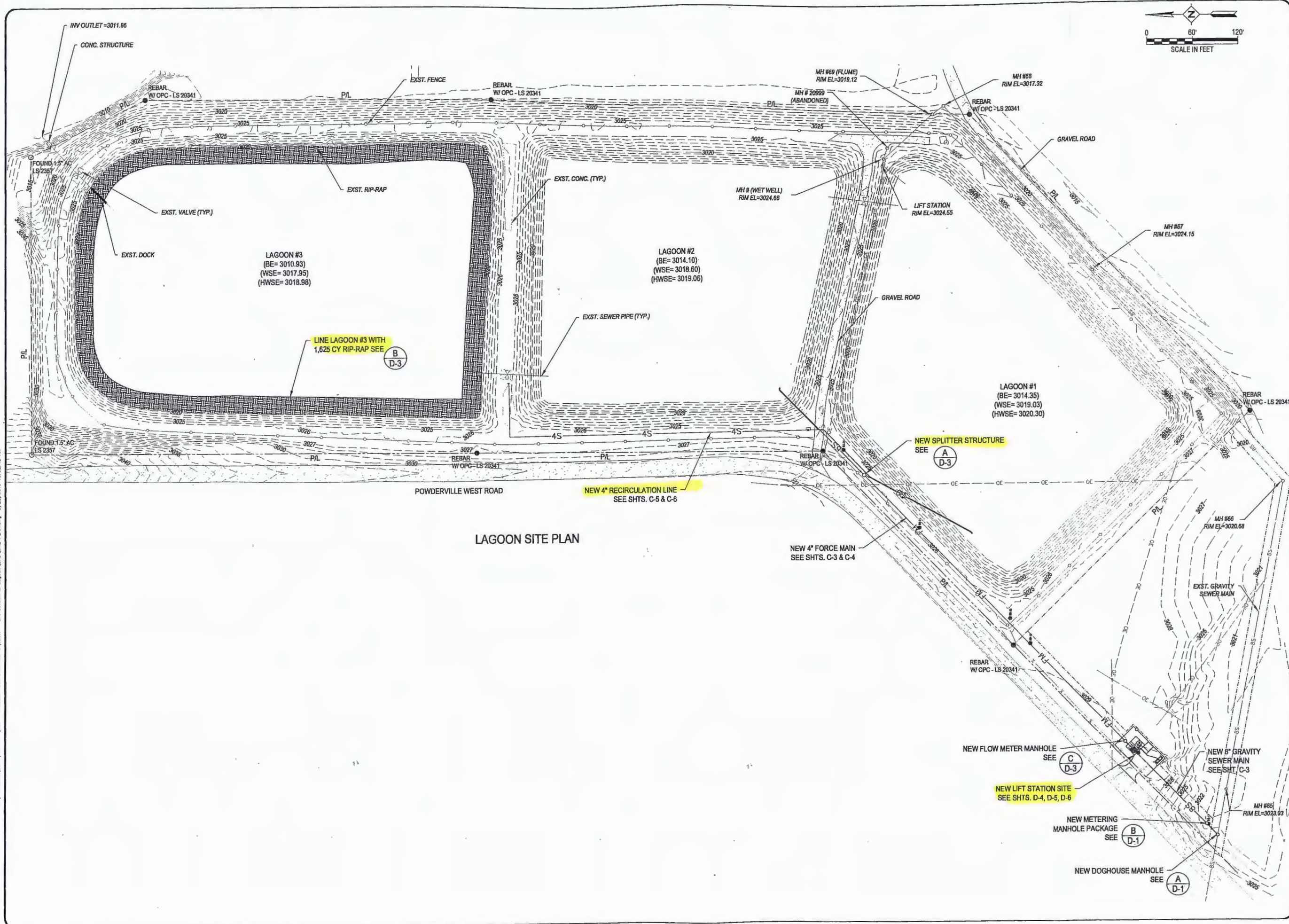

Rev No	Date	By	Description

LIFT STATION & LAGOON IMPROVEMENTS		TOWN OF BROADUS		BROADUS, MONTANA	
LAGOON SITE PLAN					
Drawn By:	KKB	Surveyed By:	ACT	Project No.:	Y-18-00-025.01
Checked By:	LC	Designed By:	LC	Date:	05/2019

Interstate Engineering, Inc.
P.O. Box 20953
1211 Grand Avenue, Suite 6
Billings, MT 59104-0953
Ph (406) 256-1920
Fax (406) 256-8178
www.interstateeng.com
Other offices in Minnesota, North Dakota and South Dakota

