

LEWIS AND CLARK COUNTY

East Helena Sulfur Dioxide Nonattainment Area

EAST HELENA SO₂ Nonattainment Area:
 The portion of East Helena and vicinity located within a 0.67 kilometer radius centered on the sinter storage building; UTM coordinate 429484mE; 5158997mN at the ASARCO East Helena facility.

* Boundary as described in the East Helena SO₂ SIP page 25.6.1 (2).

- 1 Microwave SO₂ SPM monitoring site.
 Years of Record 1974 to present.
 AIRS number 30-043-0903, UTM location Zone 12, 429700mE; 5156200mN.
- 2 McClellan Creek Road #6 SO₂ SPM monitoring site.
 Years of Record 1993 to present.
 AIRS number 30-043-0913, UTM location Zone 12, 433950mE; 5153600mN.
- 3 McClellan Creek Road #4 SO₂ SPM monitoring site.
 Years of Record 1993 to present.
 AIRS number 30-043-0911, UTM location Zone 12, 433050mE; 5155100mN.
- 4 Water Tank SO₂ SPM monitoring site.
 Years of Record 1974 to present.
 AIRS number 30-049-0702, UTM location Zone 12, 428400mE; 5159040mN.
- 5 Kennedy Park SO₂ SPM monitoring site.
 Years of Record 1974 to present.
 AIRS number 30-049-0703, UTM location Zone 12, 429520mE; 5160220mN.

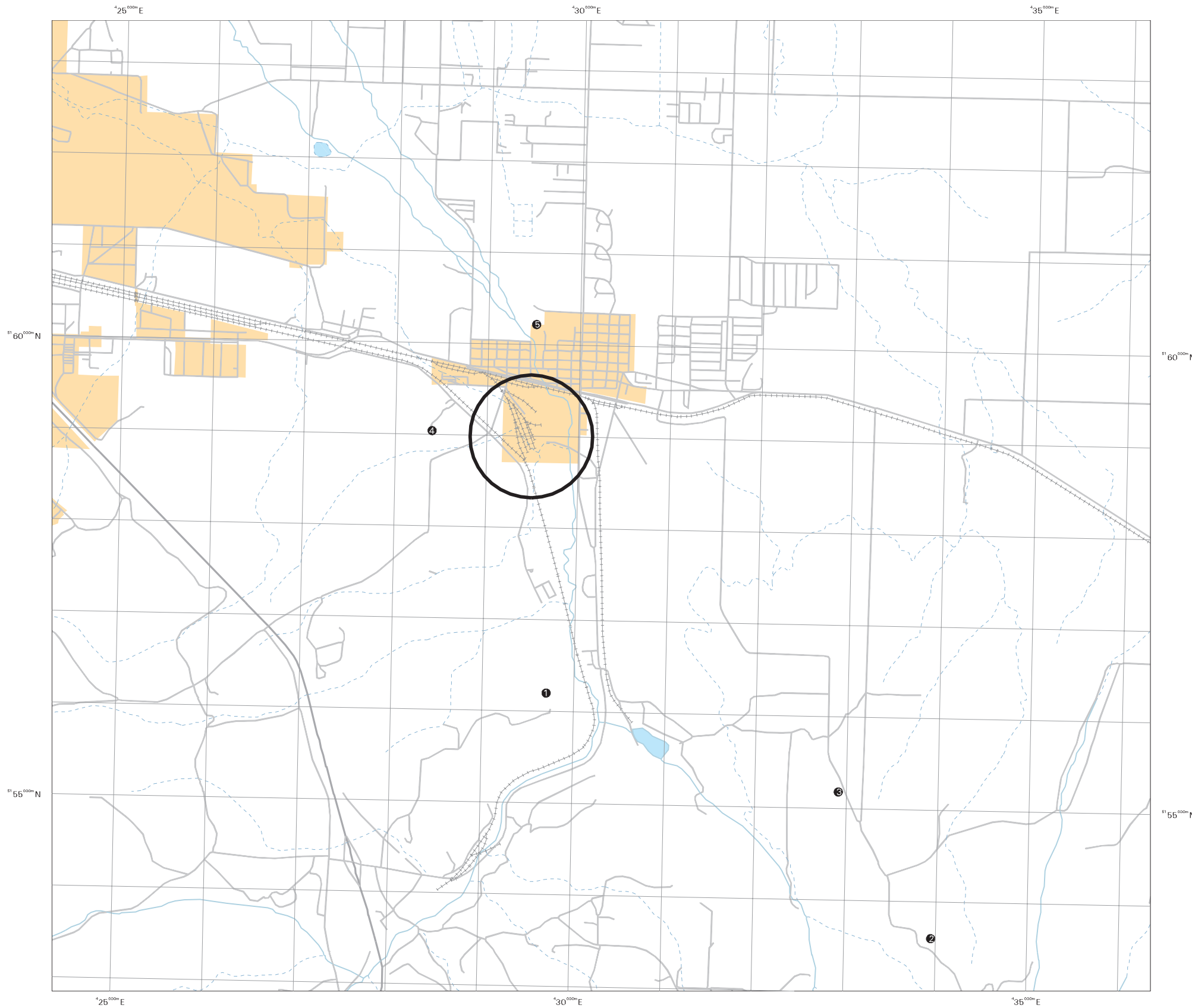

LEGEND

- Designated Sulfur Dioxide Nonattainment Area Boundary
- Improved Road
- Interstate Highway
- Trail
- Railroad
- River
- Stream
- UTM Grid
- Municipal Area
- Water Body

NRIS does not guarantee the data for functionality, accuracy, or being free from errors. The user assumes responsibility to verify usability for their purposes.

Background data from TIGER files and BLM PLSS or UTM grid generated in Arc/Info.



Scale of Feet

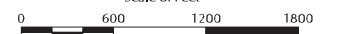

Scale of Meters

